



LIFESAVER

Low Profile Photoelectric Smoke Alarm

Model LIFPE10LP

Lithium (non-replaceable sealed in) Battery-Operated Photoelectric Smoke Alarm. Designed with style in mind, this smoke alarm has a slim line profile while providing maximum protection.



Australian
Standard
AS3786:2014

SAI GLOBAL



reddot design award
winner 2019



Thank you for purchasing this PSA LIFESAVER smoke alarm!

Please read these instructions carefully and store them in a safe place where you can access them easily.

Product description

This alarm detects particles of combustion using photoelectric technology. This smoke alarm has an expected service life of ten years under normal conditions. We recommend that you should replace after 10 years from installation date to ensure normal operation.

Test &
Hush
button

LED
indicator

Sound
output



Product Specifications

Detection method	Photo-electric Technology
Power supply	Sealed battery (3V DC)
Battery spec	CR123A
Battery lifetime	10 years
Alarm volume	≥ 85 dB (A) at 3 meters
Operating temperature	0 °C - 40 °C
Operating humidity	< 93 %
Date of replacement	See product label
Individual alarm indicator	Yes
Alarm silence facility	Yes Hush me: 5-15 minutes
Low battery warning	Yes
Low battery silence facility	Yes Hush me : 10 hours
Installation in accommodation vehicles	Yes
Mounting location	Ceiling or wall
Interconnectable	No
Comply with	AS3786:2014
Sound Pattern	ISO8201(BI 0.5s -pause 0.5s -BI 0.5s -pause 0.5s -BI 0.5s -pause 1.5s, with the RED LED flashing, repeat this alarm pattern)

Warnings

- To prevent injury, this smoke alarm must be securely attached to the ceiling/wall in accordance with the installation instructions.
- Batteries should not be exposed to excessive heat such as sunshine, fire or the like.
- Do not paint or cover the smoke alarm.

Where to install a smoke alarm

- Check specific State legislation in your area to ensure smoke alarms are correctly located according to local laws. Each State or Territory may differ in building codes and regulations. PSA Products can only recommend the locations.
- Locate an alarm for each separate sleeping area in the immediate vicinity of the bedrooms. Try to monitor the exit path as the bedrooms are usually farthest from an exit. If more than one sleeping area exist, then install additional alarms in the immediate vicinity of each sleeping area.
- Locate additional alarms to monitor any stairwells because stairwells act like chimneys for smoke and heat.
- Locate at least one alarm on every floor level.

- Locate an alarm in every room where a smoker sleeps.
- Locate an alarm in every room where electrical appliances are operated (i.e. portable heaters or humidifiers).
- Locate an alarm in every room where someone sleeps with the door closed. The closed door may prevent an alarm not located in that room from waking the sleeper.
- Smoke, heat and other combustion products rise to the ceiling and spread horizontally. Mounting the alarm on the ceiling in the center of the room places it closest to all points in the room. Ceiling mounting is preferred in ordinary residential construction.
- When mounting alarms on the ceiling locate it at least 300mm away from the side wall and 300mm away from any corner. (see diagram).
- When mounting alarms on a wall, use the inside wall. The recommended position is between 300mm and 500mm off the ceiling. (see diagram).

NOTE: The performance of smoke alarms mounted on walls is unpredictable and this mounting position is not recommended when ceiling mounting can be implemented.

Location of smoke alarm

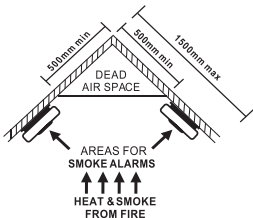

Apex Of Sloping Ceiling

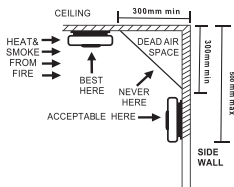

Ceiling / Wall Junction

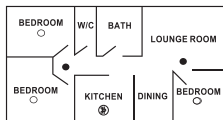

Single Floor

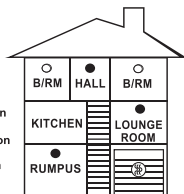

Typical Multiple Floor Installation

Where not to install a smoke alarm

- Do not locate your smoke alarm in the garage - products of combustion are present when you start your automobile. Use Lifesaver Heat Alarm in this location.
- Do not locate your smoke alarm in front of forced air supply ducts used for heating and air conditioning and other high air flow areas.
- Do not locate your alarm in areas where temperatures may fall below 0°C or rise above 40°C, or in humidity higher than 93% as these conditions may reduce battery life.
- Avoid dusty areas, dust particles may cause smoke alarm to false alarm or fail to alarm. Use Lifesaver Heat Alarm in this location to avoid false alarms.
- Avoid very humid areas or near a bathroom, moisture can cause false alarm.
- Avoid insect-infested areas.
- Do not locate alarm within 0.9m of the following: the door to a kitchen, the door to a bathroom containing a tub or shower, ceiling or whole house ventilating fans, or other high flow areas.
- Avoid locating near fluorescent lights or other electrical equipment. Install smoke alarms at least 300mm away from lights and other electrical devices.

Activation

Before commissioning the smoke alarm, it is important to activate it and test it for correct operation.

- Install the smoke alarm onto the mounting bracket. The smoke alarm will give a short beep when the alarm is fully connected to the bracket.
- Firmly press the test button for at least 3 seconds. The alarm will sound 3 short beeps – 1.5 seconds pause, then repeat it until the button is released. The initial test volume is low, then followed by full volume sound. The alarm may sound for up to a few seconds after releasing the test button, indicating that the product can be used normally.

Mounting

- Place the mounting bracket on the desired installation location and mark where the holes should be drilled.
- Drill two holes with a diameter of 5 millimeters.
- Push the plastic plugs into the holes.
- Insert the screws into the mounting bracket and tighten them firmly into the plugs.

- Place the smoke alarm on the mounting bracket and secure it by turning it clockwise. Test the correct operation of your smoke alarm by pressing the test button.
- If no sound is generated, the smoke alarm is not functioning properly and should not be used!

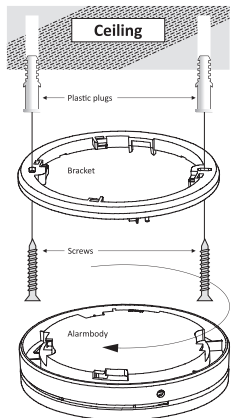

Alarm silence facility

When the smoke alarm activates, the alarm can be silenced or hushed for 5 to 15 minutes by pressing the test/hush button. After that, the smoke alarm automatically resets and returns to normal operation mode. If there are small particles of combustion in the air, the smoke alarm will activate again. **WARNING:** Before using the alarm silence facility, always identify the cause of the alarm and make sure that the circumstances are safe.

Low battery mode

When the battery is running low, the smoke alarm will indicate this with a repetitive beep and flash for approximately 30 days.

WARNING: This smoke alarm is equipped with a non-replaceable battery. When this warning occurs, replace the device as soon as possible! The low battery warning beep can be hushed for 10 hours by pressing the test/hush button. This feature allows you time to change the smoke alarm. The smoke alarm will continue to function as normal in this mode.

Fault warning mode

When the smoke sensor is not functioning properly, it will turn into the fault warning mode. Try cleaning the smoke alarm (see paragraph maintenance) or replace the smoke alarm. If the buzzer is not working correctly, the device will turn into the buzzer fault warning mode. Please immediately replace the smoke alarm when this occurs.

Night mode

This smoke alarm has an automatic night mode. In dark rooms, the LED signal will be turned off to prevent disturbance of the night's sleep.

Alarm Tamper-Resist Feature

A tamper resist feature has been provided. To activate this feature, you must break out the tamper-resist blocks on the mounting plate.

Using this feature will deter children and others from removing the alarm from the mounting plate.

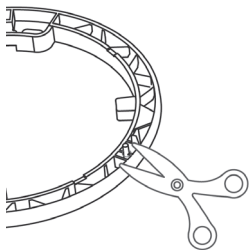

Disassembling

To disassemble the smoke alarm, take a screw driver and push it into the mounting hole. Then, turn the smoke alarm counterclockwise to remove it from the mounting bracket.

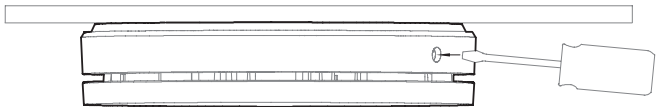

Maintenance

- This smoke alarm is equipped with a self-testing mechanism. We recommend to test the smoke detector manually at least once every three months by using the test facility. If the smoke alarm functions correctly, it will generate a loud beep. Due to the loudness of the alarm, make sure that you always stand at arm's length distance from the unit when you are testing. If the smoke alarm does not generate an acoustic signal, the smoke alarm must be replaced immediately!
- Clean the smoke alarm at least once per month to remove dirt, dust or debris. Use a vacuum cleaner with a soft brush and vacuum all sides and covers of the smoke alarm. Do not remove the top cover of the smoke alarm to clean it inside.
- Do not attempt to repair this smoke alarm. If the smoke alarm shows damage related to its functionality, it must be replaced!
- Troubleshooting: False alarm is often caused by dust or steam.

This smoke alarm has an expected service life of 10 years under normal conditions. We recommend that you should replace the smoke alarm after 10 years from installation date to ensure normal operation.

Product warranty registration

Thank you for purchasing and installing the most trusted brand in fire, security and intercoms. To ensure you receive excellent after-sale product service we encourage you to register your products.

There are a few important reasons to register your product:

1. It will ensure your investment is protected in case it is damaged or broken and we can effectively carry out any warranty claims.
2. Registration will also allow us to contact you in an unlikely event of product safety notification required under Consumer Product Safety Act.
3. Registration will also help us improve our product design to meet your needs.

**Register at: <https://www.psaproducts.com.au/register-product/>
Register this product for warranty to ensure fast and effective service.**

Overview visual & acoustic signals

Operating mode	Visual signal (flash)	Acoustic signal (beep)	Description mode
Normal	1 x per 40 second	None	Device is functioning properly
Test	1 x per second (3 x) / pause of 1.5 seconds	1 x per seconds (3 x) / pause of 1.5 seconds	Device is tested
Alarm	1 x per second (3 x) / pause of 1.5 seconds	1 x per seconds (3 x) / pause of 1.5 seconds	Device is detecting smoke
Alarm silence	1 x per 8 seconds	None	Smoke alarm signal is muted
Low battery warning	1 x per 40 seconds	1 x per 40 seconds	Battery is running low
Low battery warning silence	None	None	Low battery warning is muted
Sensor fault warning	1 x per 40 seconds	1 x per 40 seconds	Sensor is not functioning properly
Buzzer fault warning	2 x per 40 seconds	None	Buzzer is not functioning properly

Warranty and Liability

1. PSA Products Pty Ltd (ABN: 99 076 468 703) of 17 Millicent Street, Burwood 3125 Victoria, Australia warrants the model LIFPE10LP for a period of five (5) years from the date of purchase, as reflected on the Authorised Reseller's or Distributor' invoice / receipt provided to you. PSA Products Pty Ltd will repair or replace the product (at the option of PSA Products) due to any manufacturing defect, at the cost of PSA Products Pty Ltd (excluding any labour costs relating to removal or re-installation of product, and transport costs).
2. This warranty shall not apply to the product if it has been damaged, modified, insect infested, contaminated, abused or altered after the date of purchase, or if it fails to operate due to improper maintenance.
3. To the extent permitted by law, the liability of PSA Products Pty Ltd arising from the sale or under the terms of this limited warranty shall not in any case exceed the cost of replacement and subject to this clause. In no case shall PSA Products Pty Ltd be liable for consequential loss or damages resulting from the failure of the product or breach of this, or: Any other warranty, express or implied, loss or damage caused by failure to abide by the instructions supplied in the leaflets.

4. To the extent permitted by law, PSA Products Pty Ltd., makes no warranty, expressed or implied, written or oral, including that of merchantability or fitness for any particular purpose, with respect to the consumer replaceable battery if any. A product with non-serviceable built-in battery is covered under warranty of the product.
5. This warranty is provided in addition to other rights and remedies you have under law: Our goods come with guarantees that cannot be excluded under the Australian Consumer Law. You are entitled to a replacement or refund for a major failure and compensation for any other reasonably foreseeable loss or damage. You are also entitled to have the goods repaired or replaced if the goods fail to be of acceptable quality and the failure does not amount to a major failure. What constitutes a major failure is set out in the Australian Consumer Law.
6. To make a claim under warranty, take the product (with a proof of purchase) to the store where you purchased the product or contact **PSA Products Pty Ltd. Phone (03) 9888 9889 or Email: enquiry@psaproducts.com.au** with details, proof of purchase or expense claim in writing.