

# Professional Series 1080p Fixed HDCVI Mini Dome

Model: VSCVI2MPVDIR



Making analogue upgrade installations easy. Enjoy up to 5 times the resolution of D1 analogue cameras by upgrading with the Securview 1080p Full HD fixed-lens range.

## Camera Features

- Streams Full HD 1080p/2.0MP (1920 x 1080)
- Fixed 3.6mm lens; 88° viewing angle
- Up to 500m HD video transmission over coax
- Infrared illumination up to 30m
- IP66/IK10 for weather & vandal resistance
- HD/SD switchable output for analogue DVRs
- Auto white balance & 3D noise reduction
- Compact size with adjustable inner body
- Metal body with vandal dome cover

## Compatible Accessories

Accessories sold separately, additional adapters may be required.



VSBKTB200W



VSBKTA152

Model	VSCVI2MPVDIR
<b>General</b>	
Camera Style	Vandal Resistant Dome
Image Sensor	1/2.8" 2.4 Megapixel CMOS
Effective Pixels	1984 (H) x 1225 (V)
Signal Noise Ratio	> 50dB
<b>Camera</b>	
Lens	3.6mm Fixed Lens
Angle of View	88°
Electronic Shutter	1/3 ~ 1/100,000s
Minimum Illumination	0.05 Lux at F1.2 (Colour) / 0 Lux IR Active
Day/Night	Auto (ICR) / Colour / B&W
White Balance	Auto
Noise Reduction	2D / 3D
Gain Control	Auto
Backlight Compensation	BLC / HLC / DWDR
Audio Input	N/A
Transmission Distance	Over 500m via 75-3 coaxial cable
Synchronisation	Internal
OSD Menu	Support
Alarm Interface	N/A
<b>Video</b>	
Video Compression	H.264 / MJPEG
Resolution	1080p (1920 x 1080) to CIF (352 x 288)
Frame Rate	25fps (1080p and lower)
Video Output	BNC CVI HD output / CVBS SD output (switchable)
<b>Environment</b>	
Ingress Protection	IP66
Vandal Resistant	IK10
Maximum Infrared Range	30m
Power Input	12VDC
Power Consumption	< 4.0W
Dimensions	Ø110 x 81mm
Weight	0.30kg
Operating Environment	-30° to 60°C / RH95% (max)
<b>Product Diagram</b>	

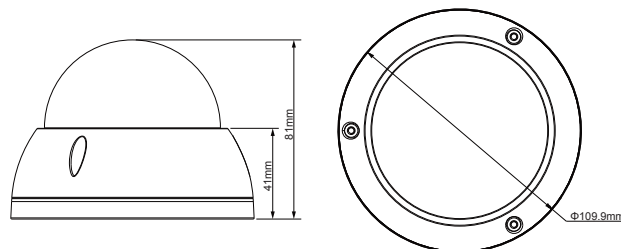

## Product Variants by Model

VSCVI2MPVDIR6	6.0mm fixed lens, 53° viewing angle
---------------	-------------------------------------

Your local Securview™ professional: