



Rhino[®]

Wireless Mobile Video Monitor 7" LCD with 2 Camera Kit

**Model No: WMVMLCD7-2C
OPERATING INSTRUCTIONS**

Specifications

Display Specifications	
Display Type	7" Colour TFT LCD
Display Resolution	800 x 480 pixels (SVGA)
AV Modes	NTSC / PAL
PSU Voltage	10 ~ 28VDC
Power	5W
Brightness/Contrast	450cd/m ² / 450:1
Operating Temp.	-20 ~ 65°C
Display Split	Single / Dual / Quad
Trigger Modes	Reverse Trigger Support

Camera Specifications	
Image Resolution	640 x 480 pixels (VGA)
Min. Illumination	0.1 Lux
Lens	2.0mm Fixed Focal Length
Infrared LEDs	12pcs
White Balance	Auto
Ingress Protection	IP66
Transmission Freq.	2.4GHz
Input Voltage	7.5VDC 500mA
Operating Cond.	-20 ~ 75°C / 95% Max. RH



Installation Instructions

Monitor - Flush Mount

1. Locate a suitable location for mounting the monitor (In-Dash, In-Wall, Headrest, etc.). Then cut a 187mm x 127mm (7³/₈" x 5") opening and insert and secure the flush-mount housing.
2. After securing the housing, insert the monitor into the housing. Do not apply pressure directly to the LCD monitor's screen. Utilise the outer edges to gently push the monitor into the housing until it snaps into place.

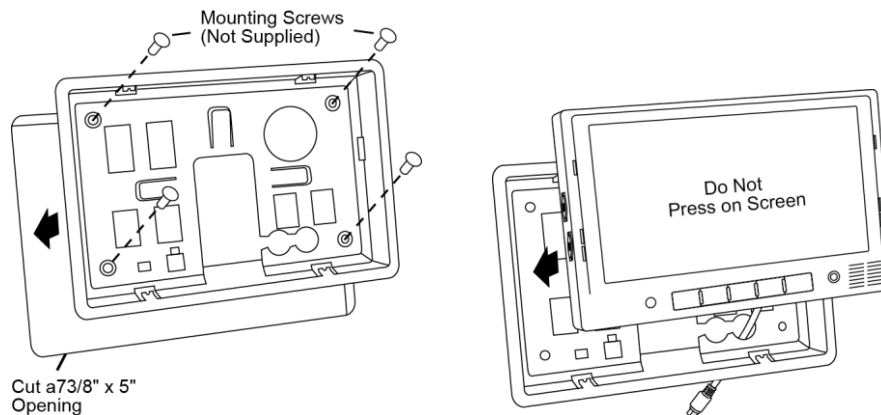

Monitor – Remove from Flush Mount

1. Insert the detaching piece as indicated. Press in and lift up and the monitor will be released from the flush mount.
2. Remove the monitor

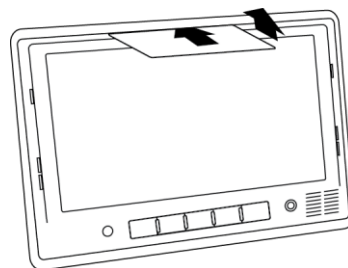

Monitor –U Bracket Mounting

1. Select a position to mount the monitor that is free of obstructions and moving parts and has a proper viewing angle.
2. Remove the mounting bracket from the monitor and use it as a template to drill the mounting holes.
3. Position the monitor mounting bracket and align with pre-drilled holes, then secure bracket with screws (not supplied).
4. Secure the monitor to the mounting bracket using adjustment thumb screws.

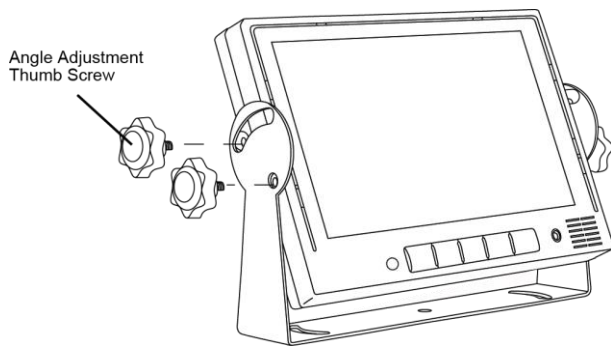



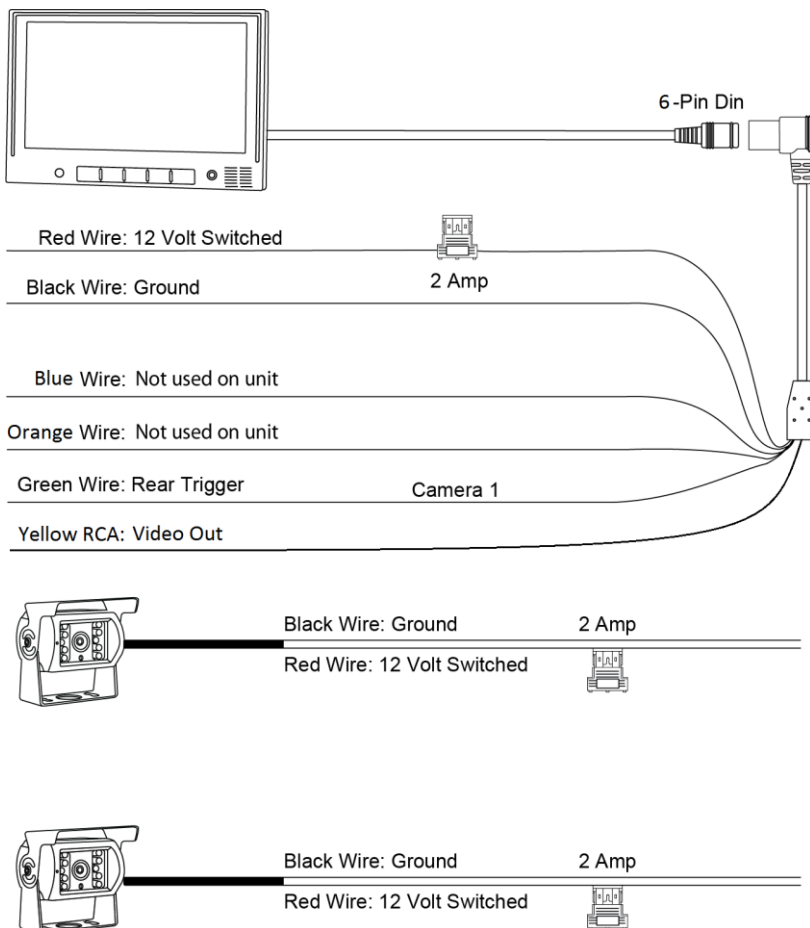





Wiring Diagram



Camera Pairing:

1. Connect Power to the Monitor without any cameras connected.

- Press the Menu button  to show menu options.
- Press the Right arrow button  to choose the  icon.
- To Select Camera # 1 (Rear Camera).
- Press  button to choose Camera # 1  icon.
- Next press  button to choose the  icon to learn in camera #1.
- The  icon will flash for about 20 seconds at this time apply power to the camera. The camera will be detected as Camera #1 – REAR Camera.
- You will see the image as CH1 and signal strength bar graph.



- Repeat for additional cameras.

2. Select a camera to pair:



Camera 1 is for rear camera only – This channel is connected with the Rear Trigger.



Camera 2 is for second camera.



Camera 3 is for third camera.



Camera 4 is for fourth camera.

3. Menu Icons.



To confirm or reactivate the camera for channel display.



To cancel or deactivate the camera for channel display.



To return to the previous menu.

To Select an Icon press the button immediately below the icon.

Select Mirror Image / Original Images for Camera 2 and 3

1. In the main menu, select the **Camera icon**



2. Select a camera (**Camera 2** and **Camera 3**)



3. Choose your image display.



For normal image.



For mirror image.

Brightness Control

1. In the main menu, select the **Camera icon**



2. Select **Brightness Control**.



3. Choose **Auto-Adjust** or **No Adjustment**



Automatic – Brightness will adjust automatically according to the surrounded environment. Screen will highlight during day time and dim at night.



No Adjustment

PAL / NTSC Video Standard (Optional)

1. In the main menu, select the **Camera icon** .



2. Select **AV icon**.



3. Choose P for PAL as this is the Australia standard.



for PAL (Australian use)



for NTSC

Limited Warranty

Cornick Pty Ltd (Seller) warrants its products to be in conformance with its own plans and specifications and to be free from defects in materials and workmanship under normal use and service for twelve months from the date of original purchase. Sellers obligation shall be limited to repairing or replacing, at its option, free of charge for materials or labour, any part which is proved not in compliance with Sellers specifications or proves defective in materials or workmanship under normal use and service. Seller shall have no obligation under this Limited Warranty or otherwise if the product is altered or improperly repaired or serviced by anyone other than Seller.

For Warranty Service: Return transportation prepaid with a copy of your purchase receipt and contact details to:

RhinoCo Technology, 9 Hannabus Place, McGraths Hill, NSW 2756 Australia.

Seller has no obligation to attend the buyer's location to retrieve the goods or make repairs onsite.

- There are no warranties, expressed or implied, of merchant ability, or fitness for a particular purpose or otherwise, which extend beyond the description on the face hereof. In no case shall seller be liable to anyone for any consequential or incidental damages for breach of this or any other warranty, express or implied, or upon any other basis of liability whatsoever, even the loss or damage is caused by its own negligence or fault.
- Seller does not represent that the products it sells may not be compromised or circumvented; that the products will prevent any personal injury or property loss by burglary, robbery, fire or otherwise; or that the products will in all cases provide adequate warning or protection. Customer understands that a properly installed and maintained alarm system or video surveillance system may only reduce the risk of a burglary, robbery, or fire without warning, but it is not insurance or a guarantee that such will not occur or that there will be no personal injury or property loss as a result.
- Consequently, seller shall have no liability for any personal injury; property damage or other loss based on a claim the product failed to give any warning. However, if seller is held liable, whether directly or indirectly, for any loss or damage arising under this limited warranty or otherwise, regard less of cause or origin, seller's maximum liability shall not in any case exceed the purchase price of the product, which shall be the complete and exclusive remedy against seller.
- This warranty replaces any previous warranties and is the only warranty made by the Seller on this product. No increase or alteration, written or verbal, of the obligations of this Limited Warranty is authorized.

Please refer to the website (www.rhinoco.com.au) for a full list of trading terms.

- END -